



MondoClad

NON-COMBUSTIBLE
PRE-FINISHED
ALUMINIUM PANELS





MondoClad.

BENEFITS

100% non-combustible to AS1530.1

This means that MondoClad® is NCC compliant, streamlining the building approvals process.

Compliant to FP1.4 for weatherproofing

MondoClad® has been tested to AS4284 and meets the criteria of the FP1.4 performance requirement for weatherproofing.

Custom sizes, colours and finishes

MondoClad® offers custom colours and sheet sizes, including oversize sheets, to ensure your design is achieved.

15-year warranty

MondoClad® offers high colour retention and will not oxidise over time. Warranty available on application and subject to approval. Contact our sales team for further information.

PVDF finish

Superior long lasting finish, no cracking when fabricated.

High quality marine grade aluminium

MondoClad® is designed to be corrosion resistant, meaning it will not oxidise, making it an ideal choice for all locations.

Easy to fabricate

When folding, routing and cutting.

Stocked in Australia

As MondoClad® is stocked locally, there are reduced lead times for delivery.

Technical support

Our team of industry professionals are available to provide their expertise and technical knowledge to assist in your product-related enquiries.

Competitively priced

MondoClad® is an affordable high-quality option.

NON-COMBUSTIBLE ALUMINIUM PANELS

MondoClad® solid aluminium panels set a new standard in high-performance, quality facades. With its exceptional fire performance, this is a non-combustible solution designed to last. Offered in an extensive range of colours, these pre-painted panels are suited to a range of applications from high-rise and education to health care and residential developments. Exclusively distributed by HVG Facades, MondoClad® is now used in new constructions and the recladding of existing projects across Australia.

A product of enduring style

MondoClad®'s wide range of finishes and sizes means that even the most complex architectural designs can be achieved. Stocked locally in numerous colours and sizes, MondoClad® also offers custom colours and measurements on request.

MondoClad® is non-combustible, and can be easily fabricated into cassettes. This combination of low-maintenance, high level of safety and durability means that architects, designers, developers, builders and contractors can specify confidently without compromising design. The superior PVDF architectural paint finish of MondoClad® also ensures UV stability and colour retention, so that architectural designs will stand the test of time.

A non-combustible solution that is designed to last

MondoClad® offers exceptional quality and fire performance. It is categorically non-combustible, in accordance with AS1530.1 standards, which sets it apart from many other market offerings.

Utilising a corrosion-resistant, marine-grade alloy, MondoClad® is ideal for use in harsh Australian conditions. The high-quality paint finish provides modern colour options with durable UV resistance and gloss retention.

MONDOCLAD® TECHNICAL DATA SHEET

Properties	Units	Values
Alloy		5052
Temper		H32
Standard thickness	mm	3
Painted weight	kg/m ²	8.31
Raw density	kg/m ³	2680
Indicative minimum radius	mm	4.5
Tensile strength	MPa	215-265
0.2% Proof stress	MPa	>160
Elongation	%	7
Linear thermal expansion		2.4mm/m at 100° temperature difference
Melting range	°c	607-650
Modulus of elasticity - Tension	GPa	69.3 @ 20°c
Modulus of elasticity - Torsion	GPa	25.9 @ 20°c
Modulus of elasticity - Compression	GPa	70.7 @ 20°c
Thermal conductivity	W/m.k	138 @ 25°c
Electrical resistivity	micro-ohm.m	70.7 @ 20°c
Electrical conductivity - Equal volume	MS/m	20 @ 20°c
Electrical conductivity - Equal weight	MS/m	67 @ 20°c
Sound adsorbion factor	NCR	0.05
Sound reflection	%	95

FIRE PERFORMANCE

MondoClad® solid aluminium panels are non-combustible when tested to AS1530.1.

Test standard	Result		
AS1530.1	Non-combustible		
AS1530.3	Pass	Ignitability index	0
	Pass	Heat evolved	0
	Pass	Spread of flame	0
	Pass	Smoke developed	2

FABRICATION

MondoClad® sheets can be fabricated into panels using various techniques.

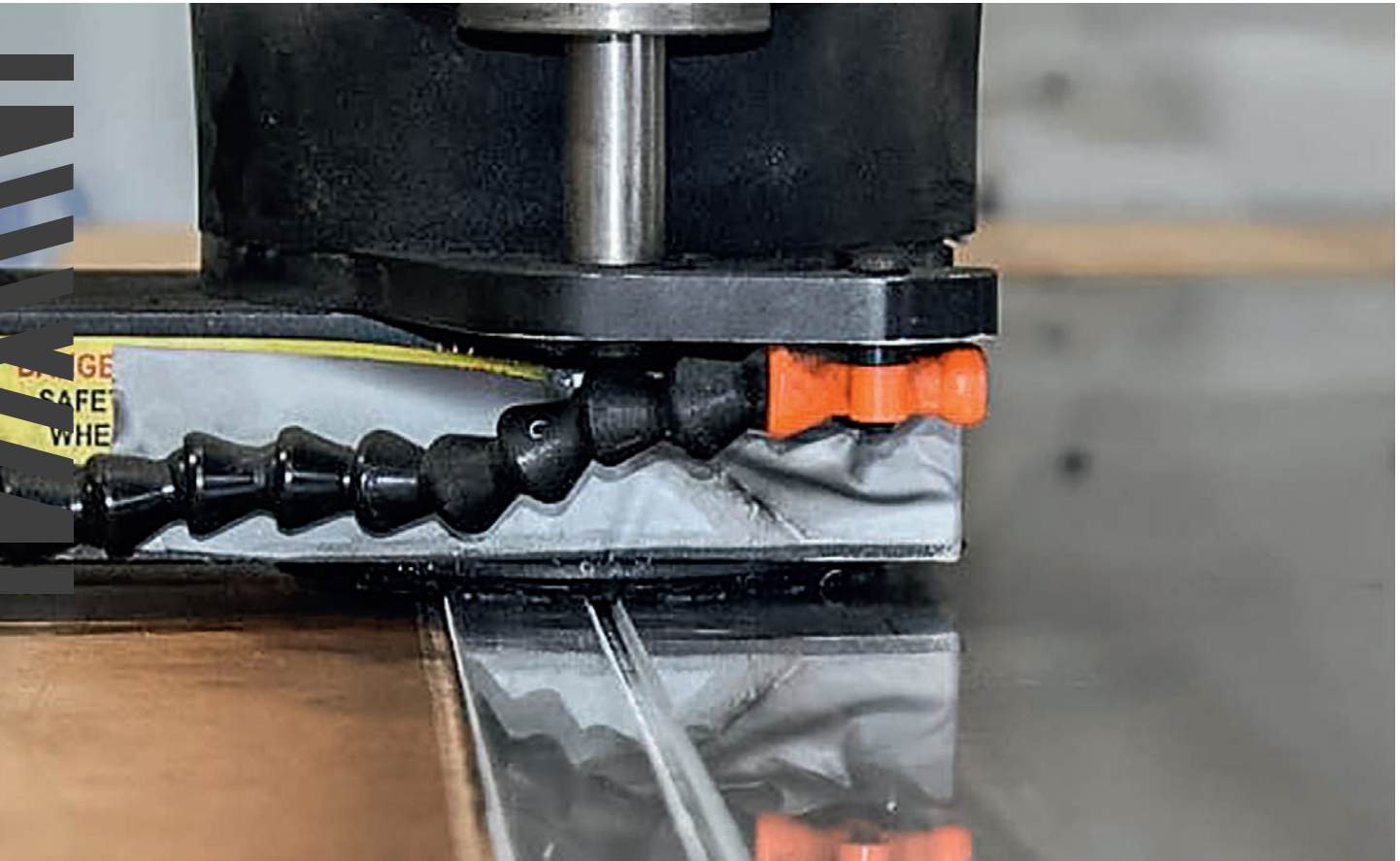

Circular Saw

For best results, a track guided circular saw is recommended. It is important to discuss blade selection with manufacturer. Hand folding is generally achievable without the need for bending equipment. A depth gauge roller suitable for 3mm thickness may be required.



Vertical Panel Saw

This type of saw can cut and route MondoClad®. Please seek manufacturer's advise in the selection of an appropriate blade. Existing vertical saws can be retro fitted with a variable speed driver controller and lubricant misting equipment. When creating a V-groove for folding, the minimum thickness left in the bottom of the groove should be 0.7mm



CNC Router

A V-groove with a flat base of 3mm is recommended to a maximum depth of 2.2mm. Spindle rotation speeds and feed rates are machine dependant and should be discussed with machine manufacturers. A lubricant mister is recommended when fabricating MondoClad®. For optimum fabrication results, we recommend consulting machine manufacturers and tooling supply companies.



Folding

After the V-groove has been formed, fold the return leg back in one movement. It is recommended that a portable folding tool be used for small panels and a folding machine/bed for larger format panels. The initial folded angle should slightly more than the final angle required.



Shearing

MondoClad® can be guillotined to the required size. Ensure the cut material is captured to prevent damage.

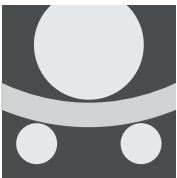

Roll Bending

To create curved surfaces, use a suitable bending machine. Safeguard the material by maintaining the protective film. Make certain the rollers are clean and dent-free. The minimum bending radius should be no more than 15 times the thickness.

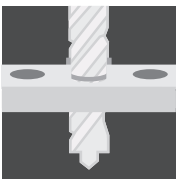

Drilling

A high quality HSS centre point drill bit is suitable for drilling MondoClad®.



Fixing

You can rivet MondoClad® using blind and solid rivets. Always consider the effects of thermal expansion and potential building movement. Stainless steel screws should be used with all MondoClad® products. Always consider the effects of thermal expansion and the possibility of building movement.

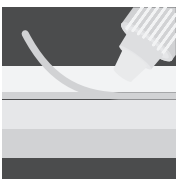

Welding

The common methods for welding MondoClad® are TIG and MIG. It is recommended to consult with your local welding specialist for advice.

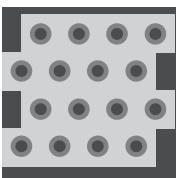

Perforating

MondoClad® can be perforated by punching, drilling or milling. Contact HVG Facades to discuss the pattern and open area you are seeking to achieve.

It is strongly recommended that you consult with machinery manufacturers and tool suppliers to secure the best fabrication result. We suggest that you conduct preliminary tests and trials prior to commencing the production of panels.

FIXING DETAILS

MondoClad®
Fixed Cassette System

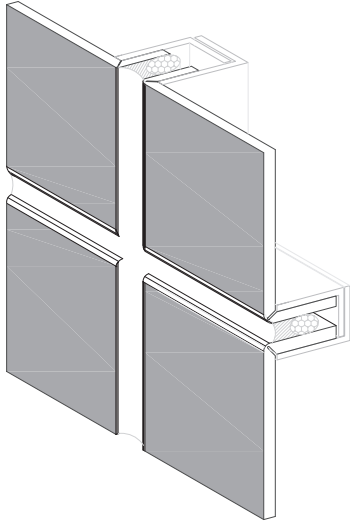

Vertical Joint-Route

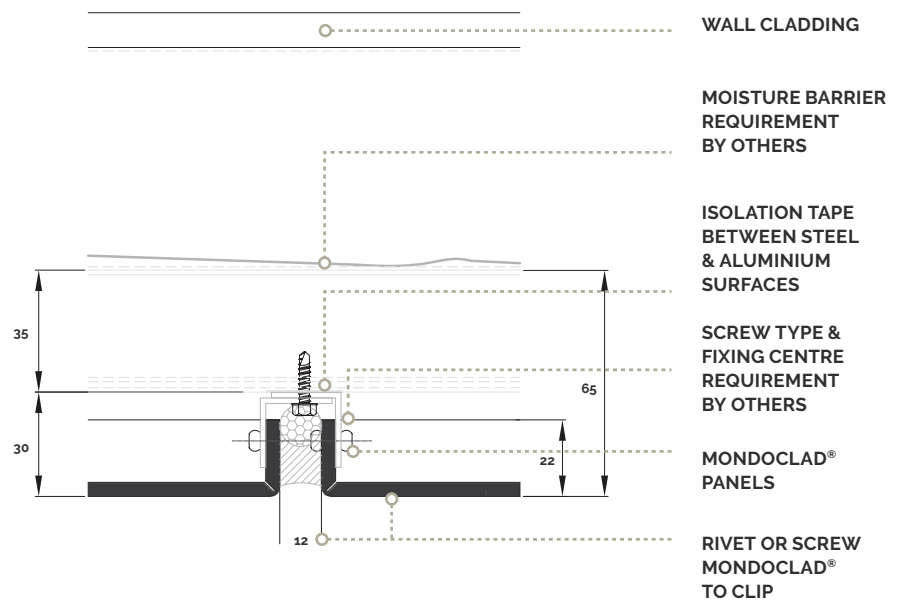

Horizontal Joint Z Angle-Route

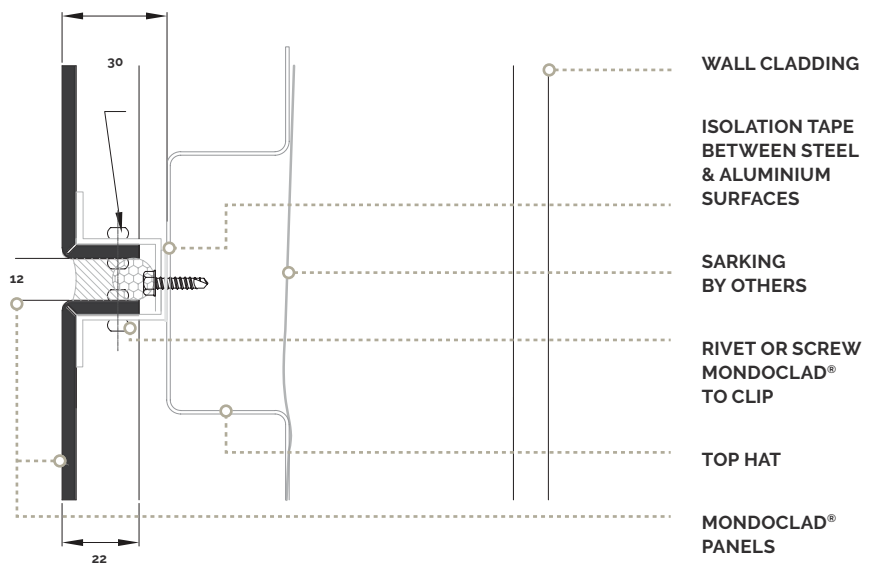

CLEANING INFORMATION

To maintain the appearance of the MondoClad® panels we strongly recommend regular cleaning with appropriate mild detergents ensuring that the detergent is thoroughly rinsed off the facade.

Never use cleaning products that are highly alkaline or acidic and avoid abrasive materials and paint dissolving solvents.

Facades that are located near a marine or industrial environment may need more frequent cleaning periods.



SUSTAINABILITY

MondoClad® is an excellent choice to enhance the sustainability of buildings due to its exceptional corrosion resistance and recyclability.

MondoClad® solid aluminium panels are 100% recyclable offering an eco-friendly solution.

Up to 95% less energy is required in the recycling of aluminium compared to other primary metals leading a reduction in emissions.



MondoClad



By **HVG** façades

hvgfacades.com.au | 1300 881 712

SYDNEY
29 Henderson Street
Turrella NSW 2205

MELBOURNE
25 West Park Drive
Derrimut VIC 3026

BRISBANE
128 Mica Street
Carole Park QLD 4300

PERTH
72 Bushland Ridge
Bibra Lake WA 6163

ADELAIDE
57 Barnes Avenue
Marleston SA 5033